

SD2



Level Information:
 +10.575 Existing site level
 +10.575 Proposed site level

KEY:
 Delineates extent of previously approved planning applications
 Zanzibar - permit P/2011/0348
 Longbeach - permit P/2012/1208

 Delineates extent of previously approved planning application
 Mimosa - permit P/2011/0348

Application P/2014/0519
 Date Approved 24.7.14

Zanzibar and Longbeach	
General Arrangement Proposed Site Plan	
Drawn: 11/150 @ A1	Scale: 1:150 @ A1
Date: March 2014	Author: [Name]
Drawn No: P01	Sheet No: P1

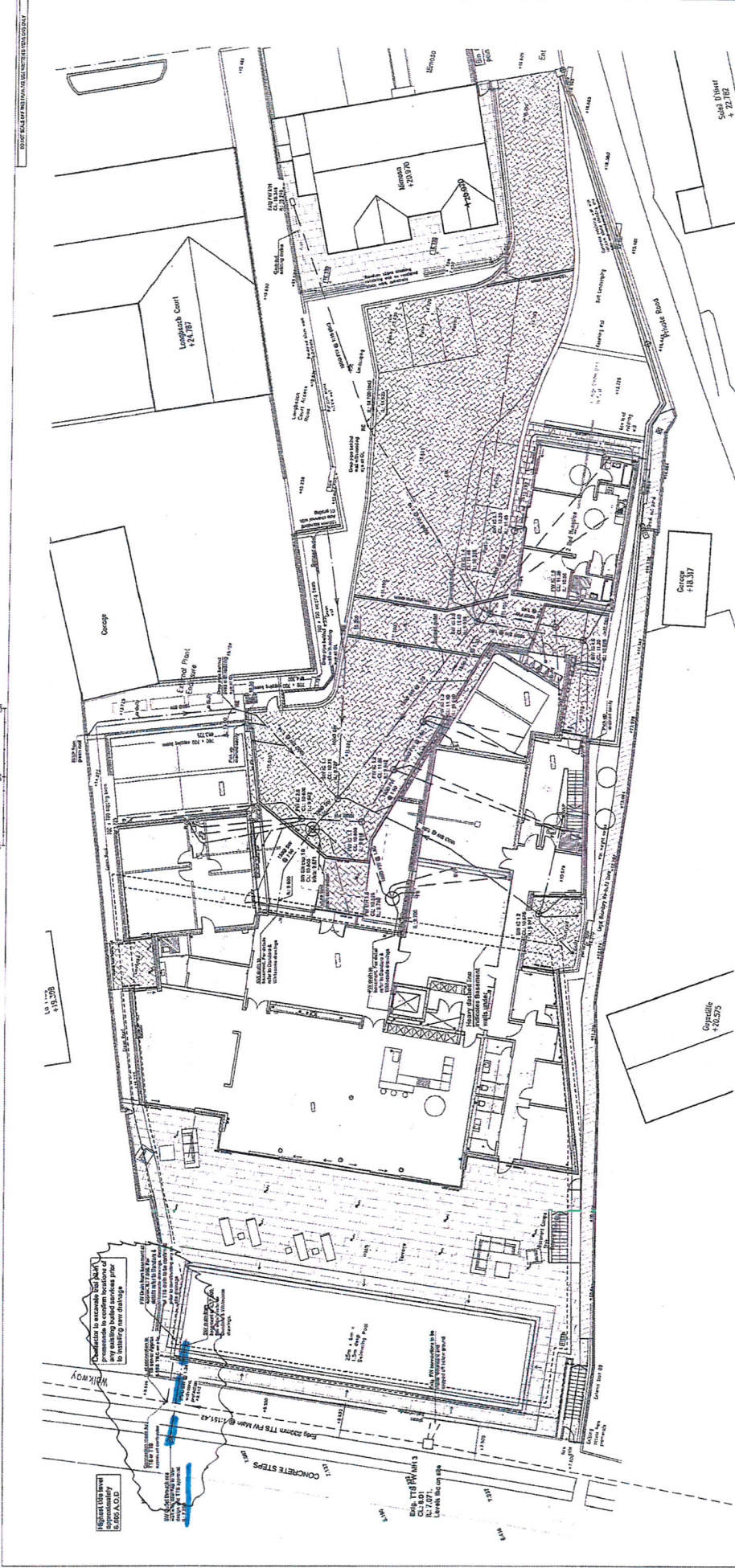

- NOTES**
1. All work shall be in accordance with the latest edition of the Australian Standard AS 1546-2005.
 2. All work shall be in accordance with the latest edition of the Australian Standard AS 1546-2005.
 3. All work shall be in accordance with the latest edition of the Australian Standard AS 1546-2005.
 4. All work shall be in accordance with the latest edition of the Australian Standard AS 1546-2005.
 5. All work shall be in accordance with the latest edition of the Australian Standard AS 1546-2005.
 6. All work shall be in accordance with the latest edition of the Australian Standard AS 1546-2005.
 7. All work shall be in accordance with the latest edition of the Australian Standard AS 1546-2005.
 8. All work shall be in accordance with the latest edition of the Australian Standard AS 1546-2005.
 9. All work shall be in accordance with the latest edition of the Australian Standard AS 1546-2005.
 10. All work shall be in accordance with the latest edition of the Australian Standard AS 1546-2005.

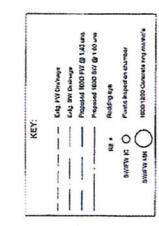

ROSS-GOWER ASSOCIATES CONSULTING ENGINEERS	
150/151 Longbush Avenue Longbush NSW 2209 Australia Tel: 61 61 655 5555 Fax: 61 61 655 5556 Email: ross@gower.com.au	
Director Ziemshaus, Mark Stöhrer 21 Brisbane Proposed Below Ground Drainage	
Date: 15/05/2014 Drawn: B. L. L.	Date: 15/05/2014 Drawn: B. L. L.
Project No: 5235/650	Sheet No: B1

SD4

DON'T SCALE OFF THIS DRAWING. USE WRITTEN DIMENSIONS ONLY

Specification Notes

- This drawing to be read in conjunction with all relevant architectural & engineering drawings
- Refer to the manufacturer's specifications for any items not listed below
- Expanses to be made in accordance with the following conditions or reinforcement prior to concreting
- Construction Sequence**
- Contractor is solely responsible for all temporary works
- Care to be taken not to undermine existing adjacent structure during excavation for new foundation or ground floor slab. Some localised underpinning may be required
- Concrete**
- Structural concrete to be grade C20/25 XS - max aggregate size 20mm vicated throughout
- Reinforcement**
- Min cover to reinforcement to be 75mm

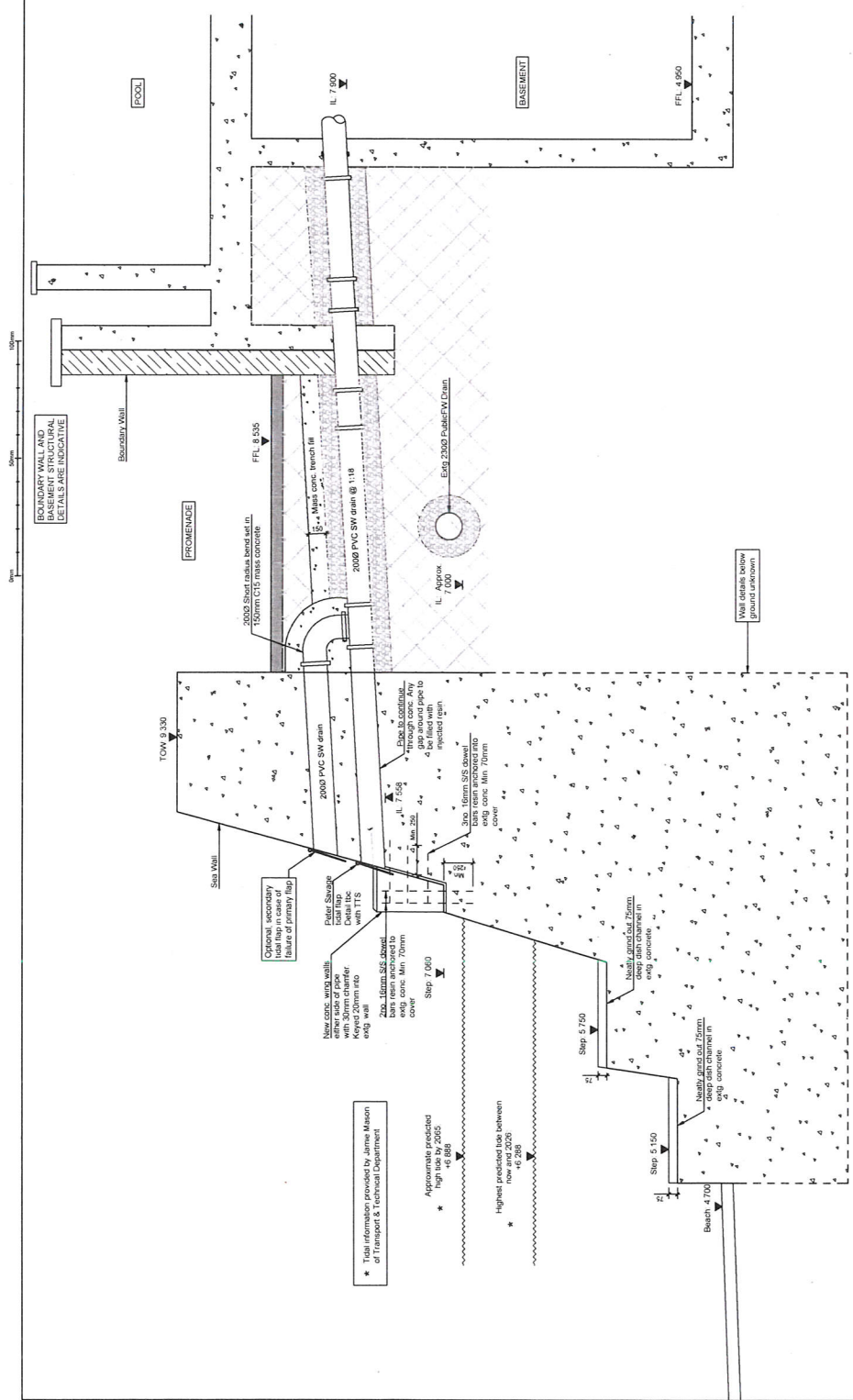

SECTION THRU SURFACE WATER OUTFALL TO BEACH

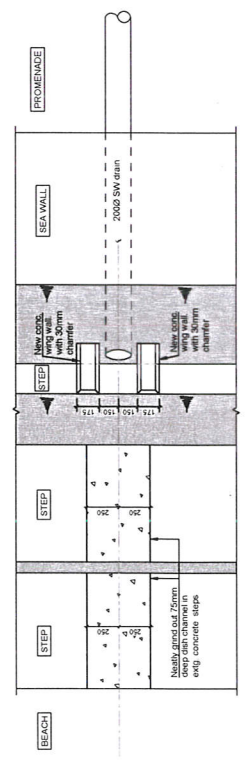

PLAN ON SURFACE WATER OUTFALL TO BEACH

C	89 05 15	Option	Secondary Detail for which Minimum of 20mm of endg wall covered	DM
B	15 06 15	Control	Site Reinforcement	DM
A	20 06 15	Revised	For Construction	DM
Rev.	15 06 15	Issue	As Issued	DM

ROSS-GOWER associates CONSULTING ENGINEERS	
15 South Beach Road, Suite 11 15 South Beach Road, Suite 11 St. Helier, Jersey, JE2 3JQ Telephone: 03334 875462 Facsimile: 03334 055922 Email: info@rga.co.uk Website: www.rga.co.uk	
Danclara Zanzibar, Mont Schier St. Helier	
Details Of Surface Water Outfall Through Sea Wall	
Scale	1:20
Project No.	5235/0
Client	Construction
Contract No.	5235/651
Sheet No.	C